

**Life Fitness Cross-Trainers 90X, 93X, 95Xe, and 95Xi**  
**How To... Replace Crankarm Cover**

Special Service Tools Required: NONE

---

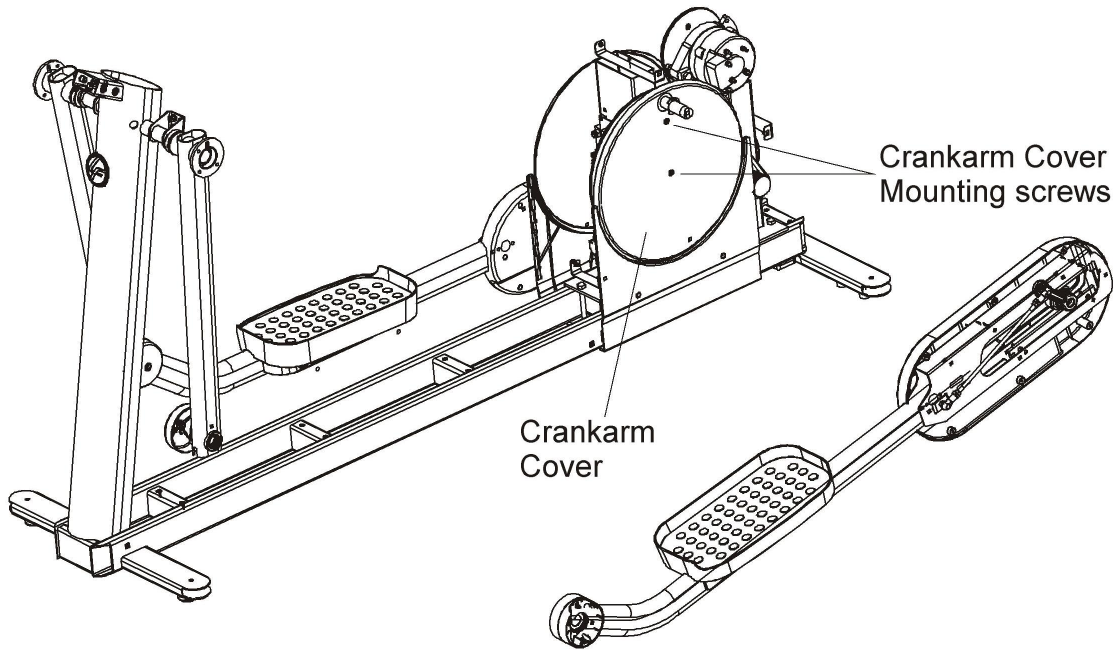

1. Remove the Main Shroud. See "How To..." in this section.
2. Remove the Outer Link Cover. See "How To..." in this section.
3. Remove the Outer Lever Joint Cover. See "How To..." in this section.
4. Remove the Pedal Lever Assembly. See "How To..." in this section.
5. Remove the Allen bolts securing the Crankarm Cover to the Crankarm
6. Install the new Crankarm Cover in reverse order.